

PG-4840-N-107USNL

48x40 (Standard) Plastic Industrial Pallet



Technical Data

Dimensions 48x40x5.1 inches
Weight 11.5 lbs

Load Capacities

Static 3300 lbs
Dynamic 2100 lbs
Racking --

Entry 4-way
Truckload Qty 2370
Stack TL 79

TL (truckload) quantities are approximate and may vary by transport equipment or other factors.

Handling Data

Nestable Yes	Reusability One-Way & Multi-Trip	ISPM-15 Exempt Yes
Stackable No	Destination Export & Captive	Food Grade Yes, non-FDA
Rackable No	Airfreight Yes	Pharmaceutical Yes



Materials and Colors

Condition
New

Material
HDPE/PP (Recycled)

Color
Black

(High-Density Polyethylene/Polypropylene)

Deck Specs

Top Deck
Open

Bottom Deck
9 Feet - Nesting

Available Options:

Closed Top Deck
3-Runner Bottom Deck (for stacking unit loads)
With perimeter lip = PG-4840-N-107US

Features

- Available in food-grade FDA material
- Top deck has no lips or safety tabs
- Designed to easily secure wrapping
- Nesting saves storage & shipping costs
- Easy-to-clean hygienic design
- Suitable for packaged food items
(not approved for direct food contact)
- Impervious to acids, fats, solvents and odors
- Resists water absorption & bacteria growth
- Inert to infestation, mold and mildew
- Consistently dimensionally accurate
- Exempt from ISPM 15 shipping regulations

NelsonTM

The Nelson Company

(443) 649-5294

plastic@NelsonCompany.com

www.NelsonCompany.com

www.NelsonTechCenter.com

PG-4840-N-107USNL

48x40 (Standard)
Plastic Industrial Pallet



Technical Drawings

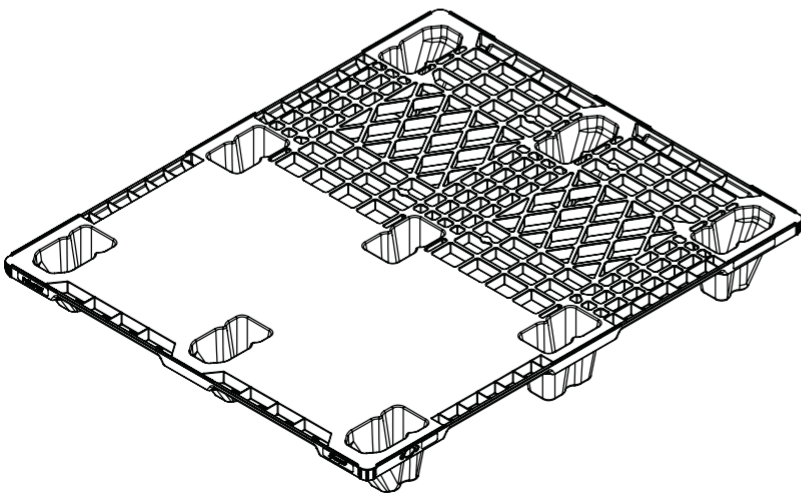
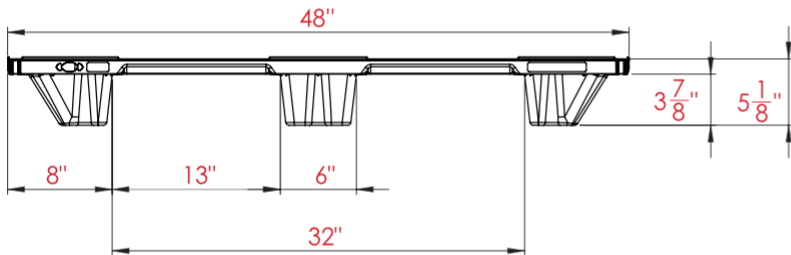
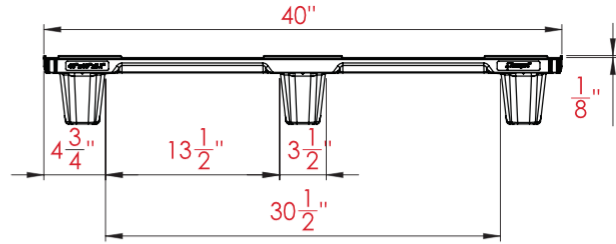
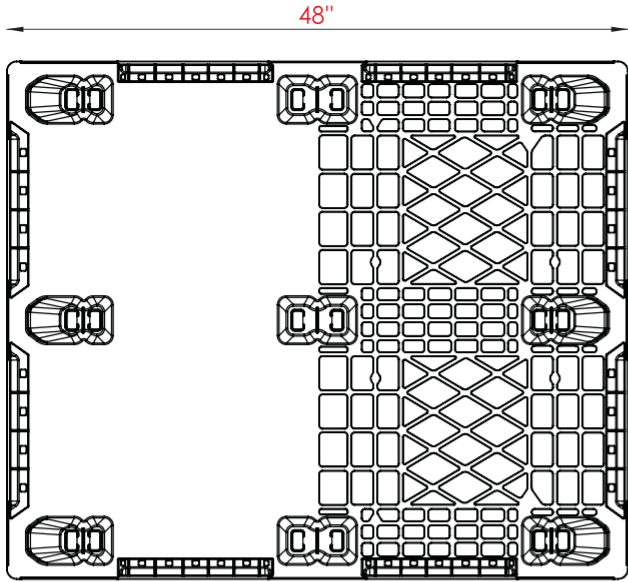

Nelson™

The Nelson Company

(443) 649-5294

plastic@NelsonCompany.com

www.NelsonCompany.com

www.NelsonTechCenter.com